

Building Control



LINCS BUILDING
CONSULTANCY

Guidance Note No. 18

Timber Upper Floors

Timber Upper Floors

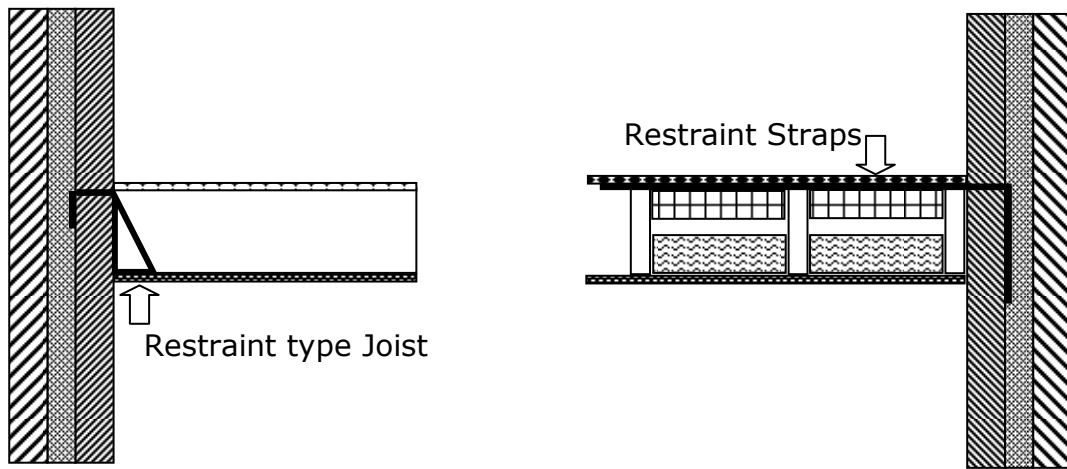

Joists perpendicular to wall

Joists parallel to wall



Brickwork



Cavity Wall



Sound Insulation



Timber Decking



Blockwork



Timber Joists



Plasterboard



Timber Noggings

Notes

1. These details assume that timber joists have been sized according to span and loads they are required to carry.
2. The details are primarily intended for domestic buildings.
3. Joists should be supported on restraint type joist hangers where they are supported by external walls.
4. Lateral restraint straps should be provided at 2.0m centres and fixed to noggings and floor joists.
5. Decking should be flooring grade and be at least 15kg/m² for sound resisting purposes.
6. Plasterboard ceiling should be at least 10kg/m² for sound resisting purposes.
7. Sound Insulation should be at least 100mm fibreglass or similar.



FS58945



Lincs Building Consultancy

**Tedder Hall
Manby Park
Louth
Lincolnshire
LN11 8UP**

**Tel: 08707 551696
Fax: 01507 327069
www.e-lindsey.gov.uk
E-mail: lbc@lincsbc.gov.uk**

If you would like to receive this information in another language or in another format, such as large print, Braille or on an audio tape, please contact Administration at either of the offices shown above.

Please note that these guidance notes are for advice only and may not cover all situations. It is your responsibility to ensure that they are appropriate for use in your particular circumstances.